

Mouse Configuration

Position: My computer→ctrlpanel→System→Mouse

The picture below is mouse configuring interface, the configuring of mouse contains four parts.



When using common user's login, the last "configuring" label will not appear.

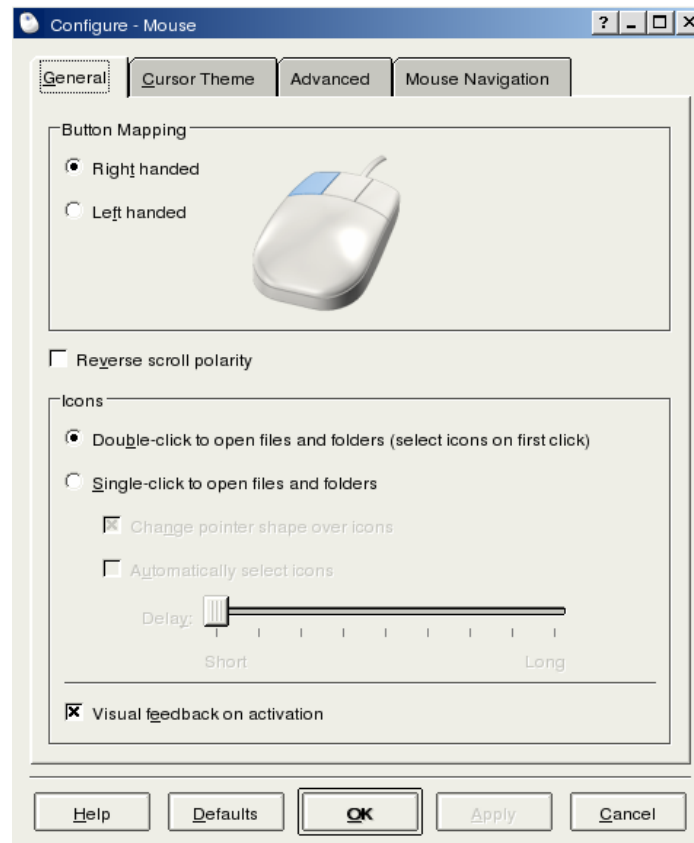

Configure mouse-1

- **General**

Set mouse as left handed or right handed, click or double click to open the impression of files, content and mouse.

- **Cursor theme**

Users can choose their favorite shape for mouse here, Asianux 2.0 provides many kinds of manner of mouse.

- **Advanced**

Set the properties of moving、 double-click etc. of mouse.

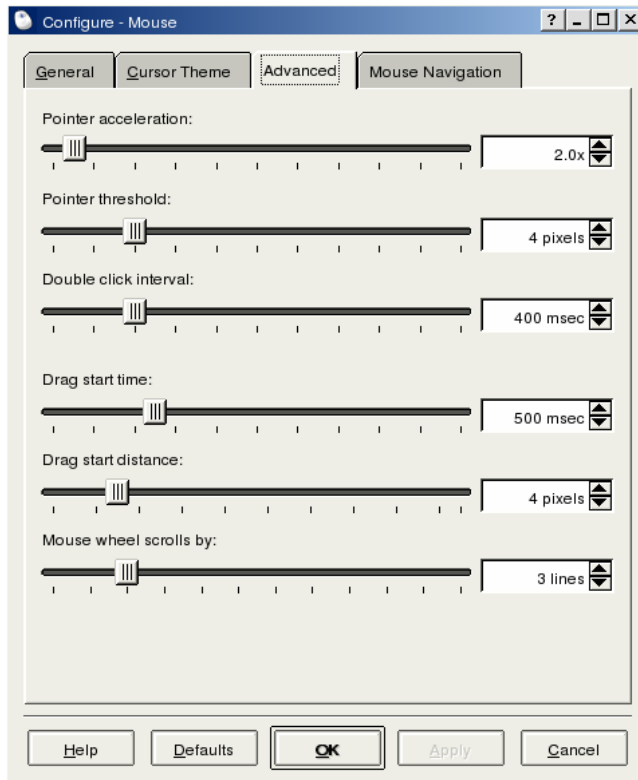

Advanced setting of mouse

- **Mouse Navigation**

Set the property of moving mouse by using keyboard (numeric keyboard).